

DIGITAL SPHERICAL ANVIL TUBE MICROMETERS/SNAP GAUGES

IP65
WATERPROOF

NON-ROTATING
SPINDLE

ABSOLUTE ENCODER, THE ORIGINAL
DATA REMAINS AFTER POWER OFF

ONE TURN OF SLEEVE MAKES 10MM SPINDLE FEED,
PRESS THE FORK, THE SPINDLE RETRACTS 3MM

MEASUREMENT ACCURACY IS NOT
AFFECTED BY THE USE OF SLEEVE

INSPECTION
CERTIFICATE

ATTENTION: RECHARGEABLE BATTERY,
FOR 24 HOURS CONTINUOUS WORKING

DATA
OUTPUT



VIDEO

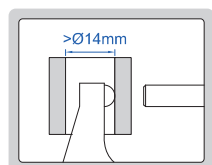

3355-251

- Measure wall thickness of tubes
- Absolute encoder, the original data remains after power off
- Resolution: 0.001mm/0.00005"
- One turn of sleeve makes 10mm spindle feed
- Measurement accuracy is not affected by the use of sleeve
- Press the fork, the spindle retracts 3mm
- Carbide measuring faces
- Measuring force 5-10N
Customizable measuring force range 3-11N
Attention: small measuring force will reduce the dustproof and waterproof level
- Button function: data output, tolerance, data preset, data hold, measuring direction change, max./min./TIR, power off time, on/off, zero, mm/inch
- Supplied with gauge blocks for zero setting (except 0-25mm/0-1")
- Power: rechargeable battery, for 24 hours continuous working

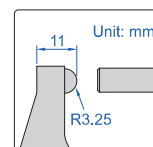
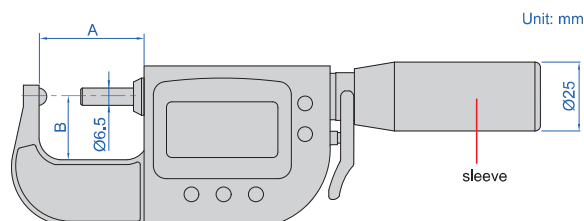

With data interface (optional wireless transmitter code 7315-3350, receiver is needed page 9)

Code	Range	Accuracy	Repeatability	A	B
3355-251*	0-25mm/0-1"	2µm	1µm	38mm	24mm
3355-501*	25-50mm/1-2"	2µm	1µm	64mm	32.5mm
3355-751*	50-75mm/2-3"	3µm	1µm	89mm	46mm
3355-1001*	75-100mm/3-3.95"	3µm	1µm	114mm	60mm

Built-in wireless (receiver code 7315-2/3/6/7/8/9 is needed)

Code	Range	Accuracy	Repeatability	A	B
3355-251WL*	0-25mm/0-1"	2µm	1µm	38mm	24mm
3355-501WL*	25-50mm/1-2"	2µm	1µm	64mm	32.5mm
3355-751WL*	50-75mm/2-3"	3µm	1µm	89mm	46mm
3355-1001WL*	75-100mm/3-3.95"	3µm	1µm	114mm	60mm

* Supplied with manufacturer inspection certificate

alarm when
over tolerance

